

Technical Specification

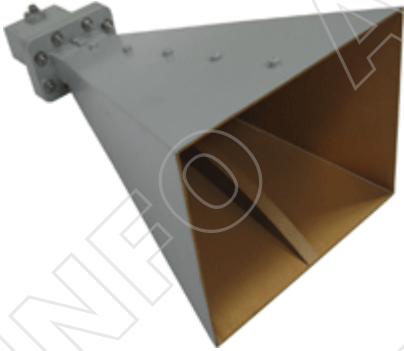

| | | |
|----------------------------------|------------------------------------|-----|
| Frequency Range(GHz) | 3.5 - 8.2 | |
| Gain(dB) | 15 Typ. | |
| Polarization | Linear | |
| VSWR | 2.0 Max | |
| Cross Polarization Isolation(dB) | -20 Max | |
| Waveguide(A Type) | WRD350D24 | |
| Adapter(C Type) | 350DRWCAN / 350DRWCAS | |
| Connector(C Type) | N-F / SMA-F | |
| Power Handling(W) CW | N-F | 150 |
| | SMA-F | 50 |
| Size(mm) | 157x131x285 (Including Adapter) | |
| Net Weight(Kg) | 0.55 Around (Including Adapter) | |

Outline Drawing (Size: mm)

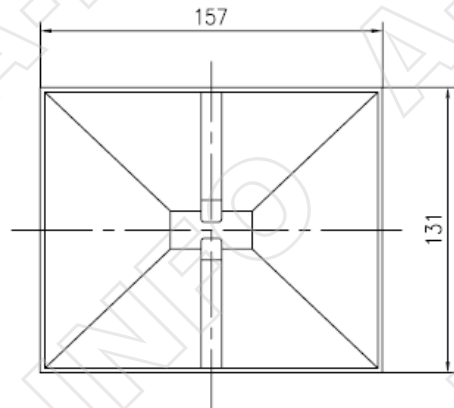
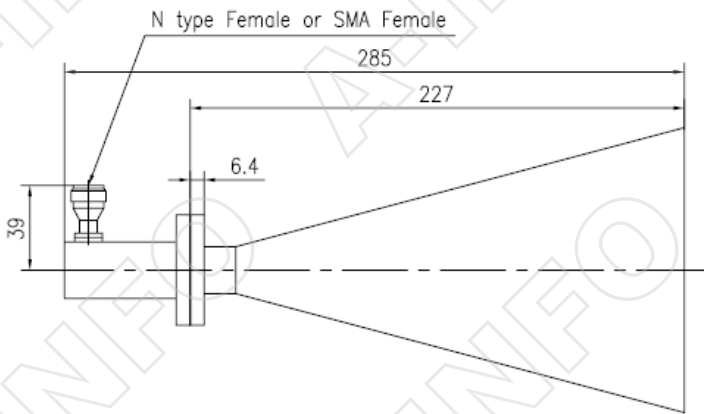

Flange Drawing (Size: mm)

FPWRD350D24

(With four through mounting holes
and four screws holes)

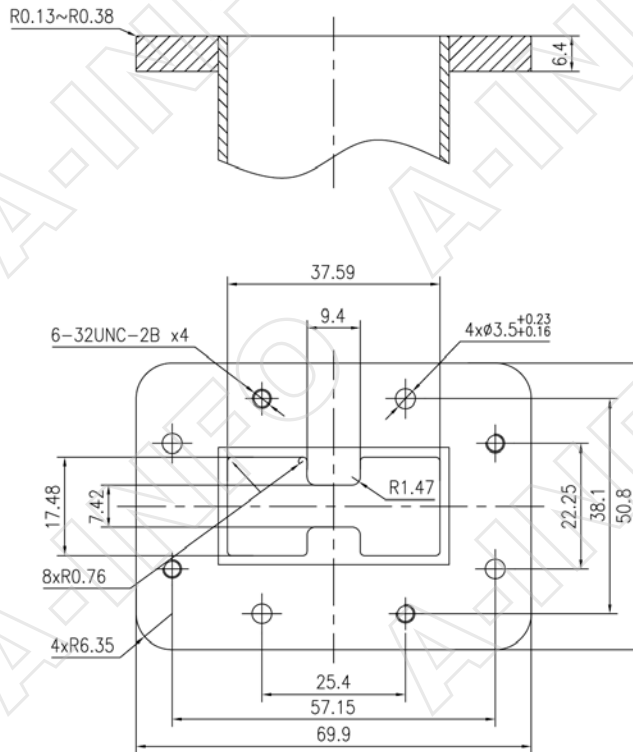

Test Results

1. Gain

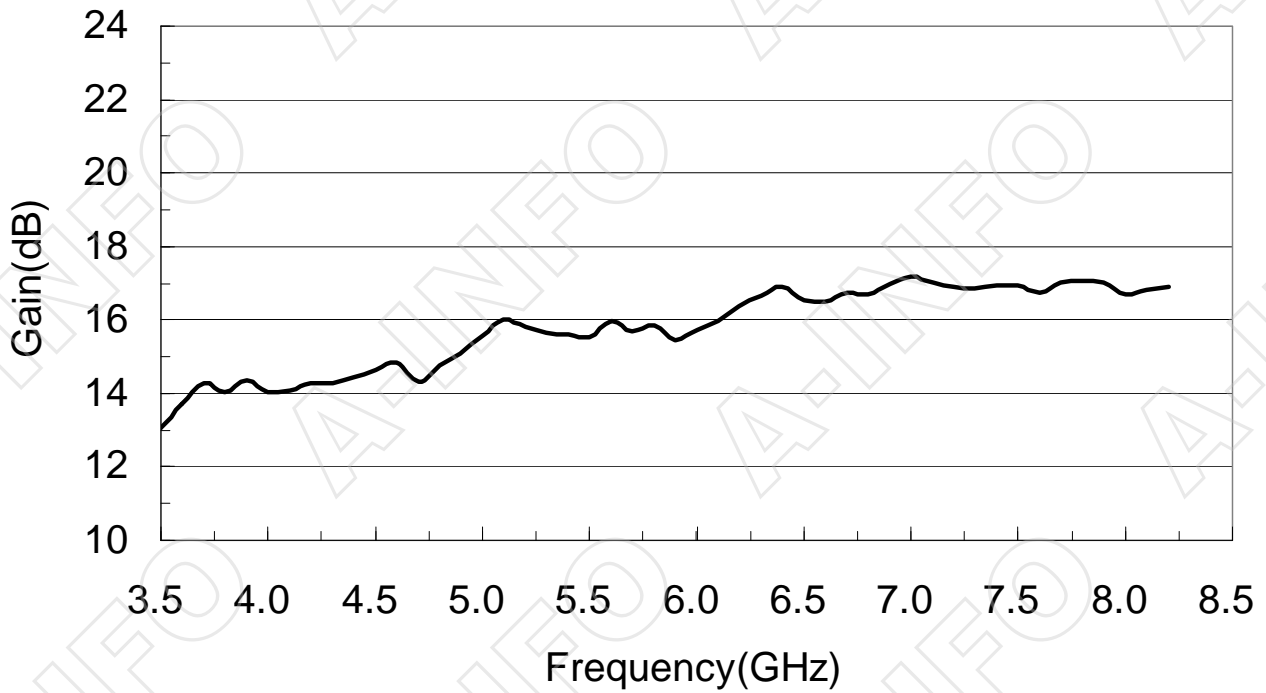

2. Antenna Factor

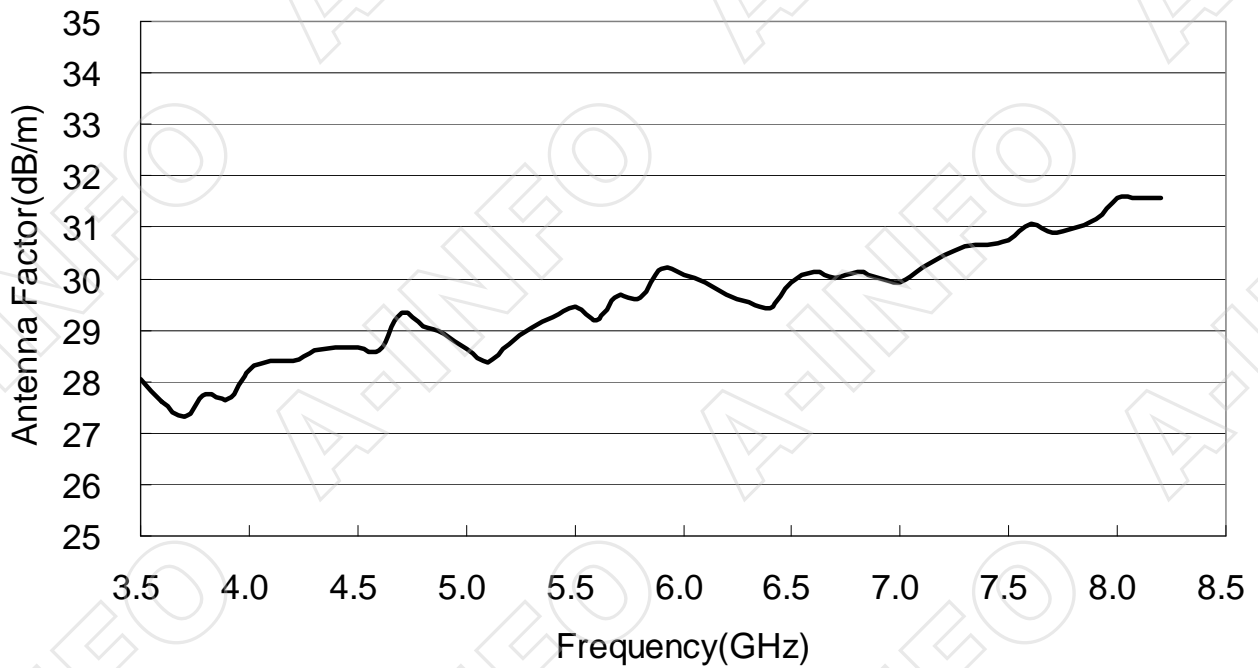

3. VSWR

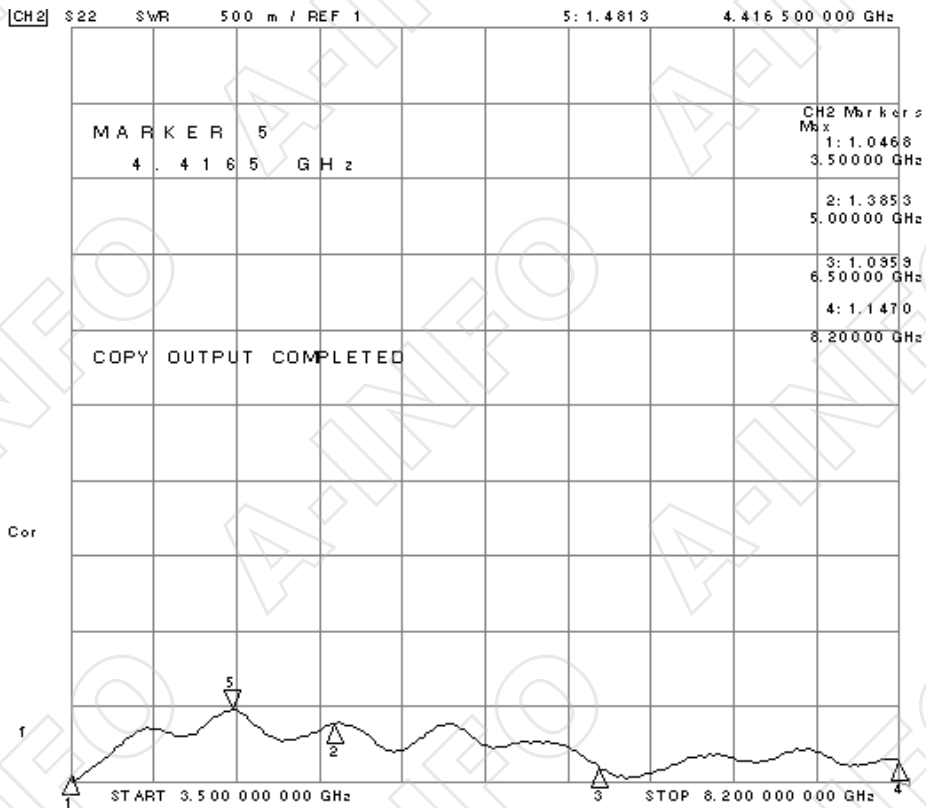

4. Cross Polarization Isolation

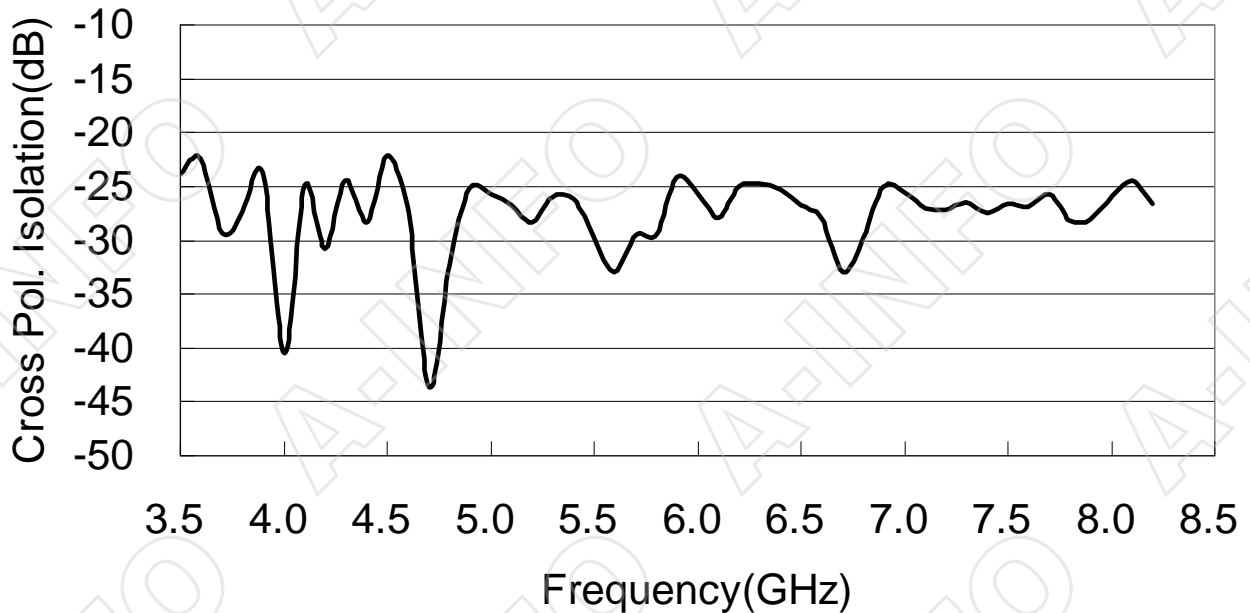

5. Pattern

3.5GHz

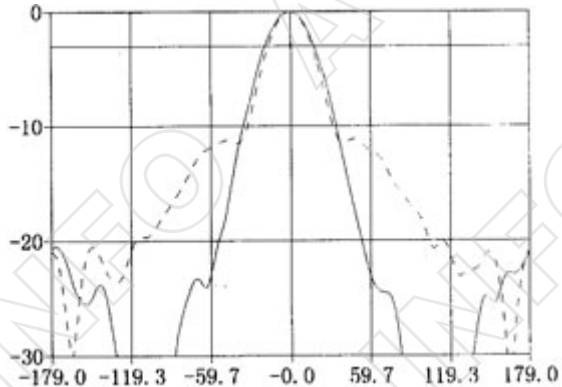

H-Plane ——— E-Plane - - - - -

3dB Beamwidth (deg): 36.70 3dB Beamwidth (deg): 32.86

4.0GHz

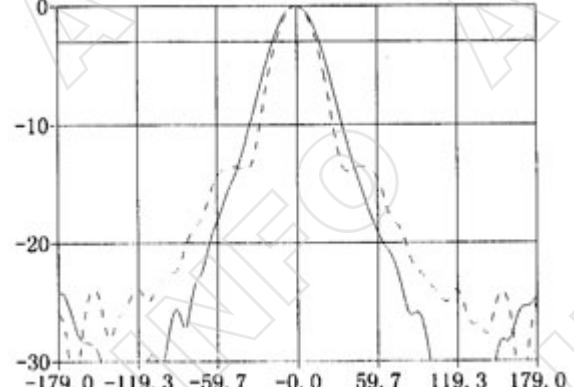

H-Plane ——— E-Plane - - - - -

3dB Beamwidth (deg): 34.71 3dB Beamwidth (deg): 30.03

4.5GHz

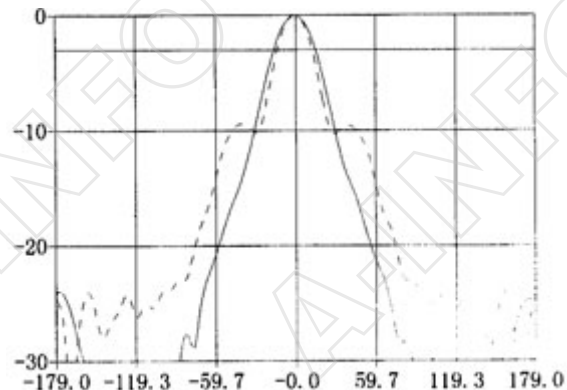

H-Plane ——— E-Plane - - - - -

3dB Beamwidth (deg): 30.91 3dB Beamwidth (deg): 26.19

5.0GHz

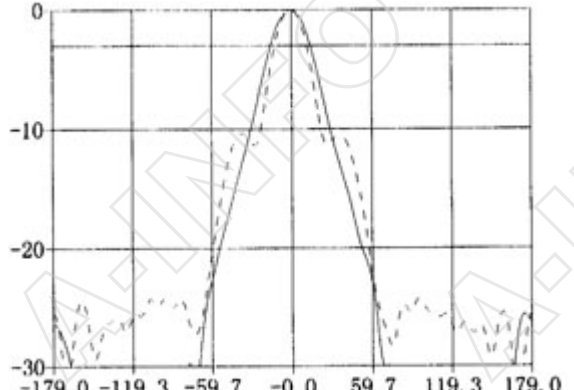

H-Plane ——— E-Plane - - - - -

3dB Beamwidth (deg): 29.55 3dB Beamwidth (deg): 23.88

5.5GHz

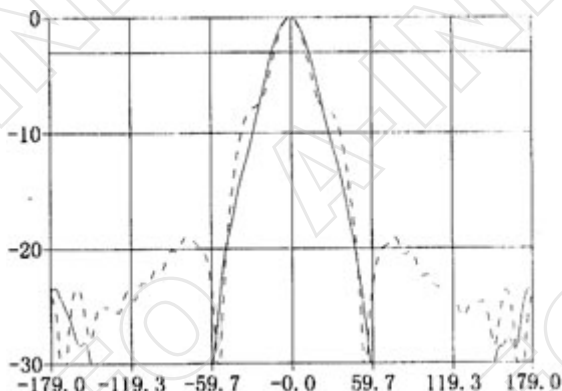

H-Plane ——— E-Plane - - - - -

3dB Beamwidth (deg): 27.58 3dB Beamwidth (deg): 23.64

6.0GHz

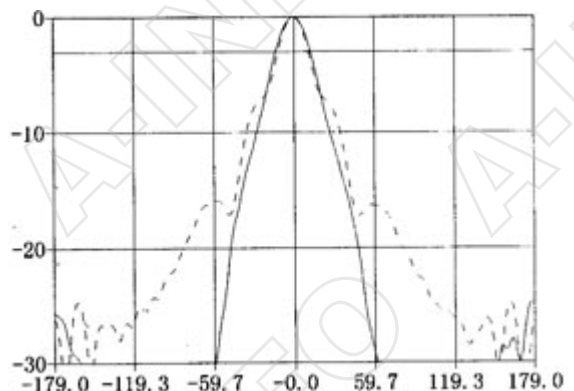

H-Plane ——— E-Plane - - - - -

3dB Beamwidth (deg): 25.82 3dB Beamwidth (deg): 22.66

6.5GHz

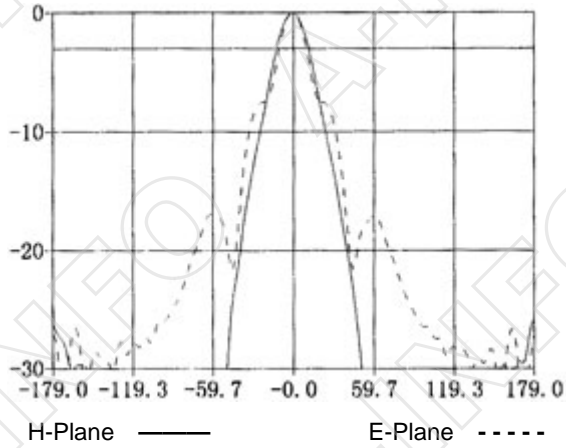

3dB Beamwidth (deg): 23.80 3dB Beamwidth (deg): 19.93

7.0GHz

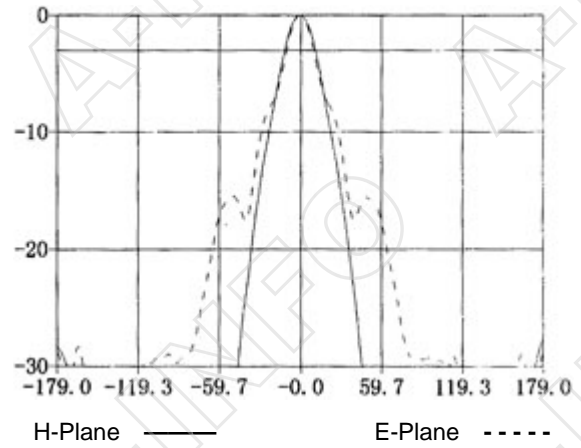

3dB Beamwidth (deg): 22.52 3dB Beamwidth (deg): 19.76

7.5GHz

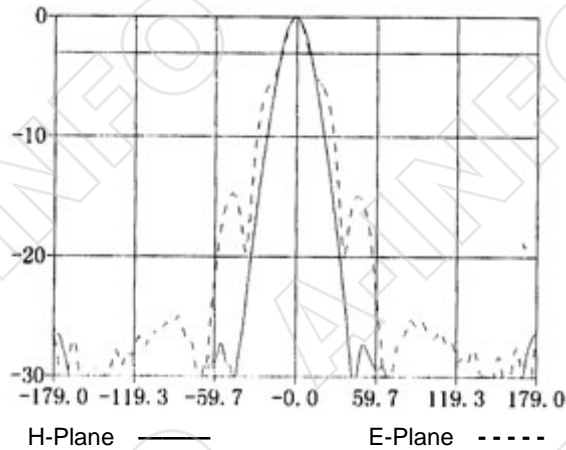

3dB Beamwidth (deg): 21.44 3dB Beamwidth (deg): 20.02

8.0GHz

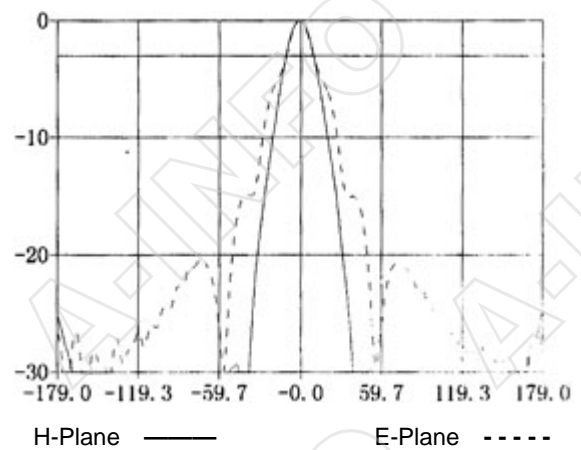

3dB Beamwidth (deg): 20.28 3dB Beamwidth (deg): 19.81

8.2GHz

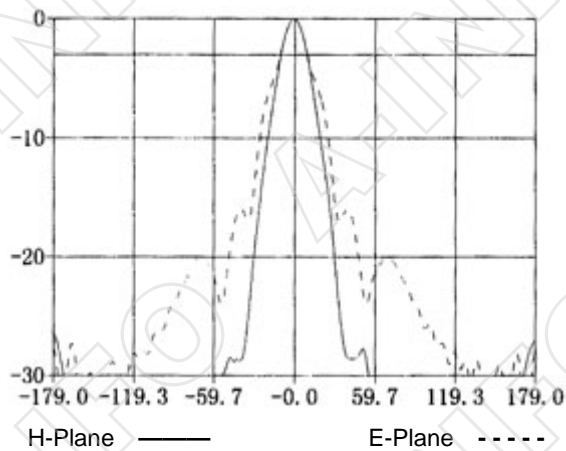

3dB Beamwidth (deg): 19.24 3dB Beamwidth (deg): 19.72